



PULEGGE DENTATE A BUSSOLA CONICA PER CINGHIE HTD®

HTD® TIMING BELT PULLEYS FOR TAPER BUSHES

5M

PASSO 5 mm

PER CINGHIE LARGHEZZA 15 mm

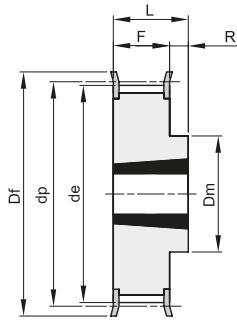

10F

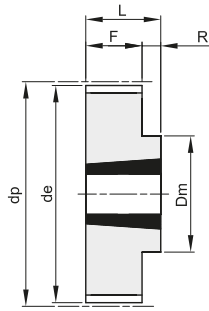

10

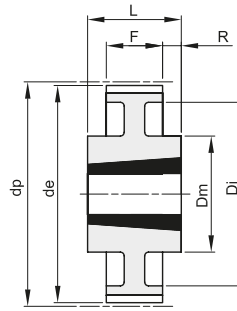

13

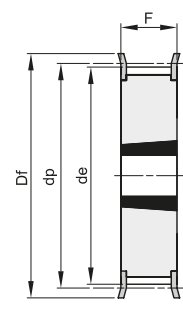

15F

Materiale: Acciaio (St)

| descrizione | codice | tipo | materiale | denti | bussola | foro max | dp | de | Df | Dm | Di | F | L | R | n° flangia | Kg. |
|-------------|----------|------|-----------|-------|---------|----------|--------|--------|-----|-----|-----|----|----|----|------------|------|
| TL 34 5M 15 | 46015034 | 15F | St | 34 | 1008 | 25 | 54,11 | 52,97 | 57 | | | 22 | 22 | | 213 | 0,20 |
| TL 36 5M 15 | 46015036 | 15F | St | 36 | 1108 | 25 | 57,30 | 56,15 | 60 | | | 22 | 22 | | 214 | 0,25 |
| TL 38 5M 15 | 46015038 | 15F | St | 38 | 1108 | 25 | 60,48 | 59,34 | 66 | | | 22 | 22 | | 216 | 0,30 |
| TL 40 5M 15 | 46015040 | 15F | St | 40 | 1108 | 25 | 63,66 | 62,52 | 71 | | | 22 | 22 | | 217 | 0,35 |
| TL 44 5M 15 | 46015044 | 15F | St | 44 | 1108 | 25 | 70,03 | 68,89 | 75 | | | 22 | 22 | | 218 | 0,40 |
| TL 48 5M 15 | 46015048 | 10F | St | 48 | 1210 | 32 | 76,39 | 75,25 | 83 | 59 | | 22 | 25 | 3 | 219 | 0,46 |
| TL 56 5M 15 | 46015056 | 10F | St | 56 | 1210 | 32 | 89,13 | 87,99 | 93 | 70 | | 22 | 25 | 3 | 222 | 0,60 |
| TL 64 5M 15 | 46015064 | 10F | St | 64 | 1210 | 32 | 101,86 | 100,72 | 106 | 80 | | 22 | 25 | 3 | 224 | 0,80 |
| TL 72 5M 15 | 46015072 | 10 | St | 72 | 1610 | 42 | 114,59 | 113,45 | | 92 | | 22 | 25 | 3 | | 1,20 |
| TL 80 5M 15 | 46015080 | 10 | St | 80 | 1610 | 42 | 127,32 | 126,18 | | 92 | | 22 | 25 | 3 | | 1,76 |
| TL 90 5M 15 | 46015090 | 10 | St | 90 | 1610 | 42 | 143,24 | 142,10 | | 92 | | 22 | 25 | 3 | | 2,32 |
| TL112 5M 15 | 46015112 | 10 | St | 112 | 2012 | 50 | 178,25 | 177,11 | | 110 | | 20 | 32 | 12 | | 3,72 |
| TL136 5M 15 | 46015136 | 13 | St | 136 | 2012 | 50 | 216,45 | 215,31 | | 110 | 199 | 20 | 32 | 6 | | 3,82 |



PULEGGE DENTATE A BUSSOLA CONICA PER CINGHIE HTD®

HTD® TIMING BELT PULLEYS FOR TAPER BUSHES

8M

PASSO 8 mm

PER CINGHIE LARGHEZZA 20 mm

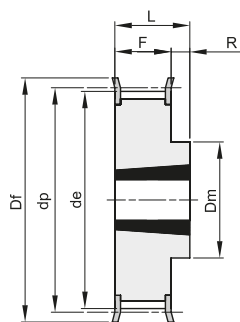

10F

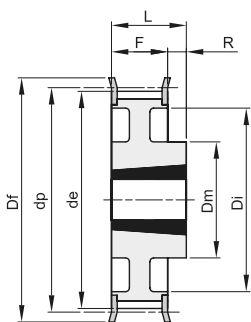

11F

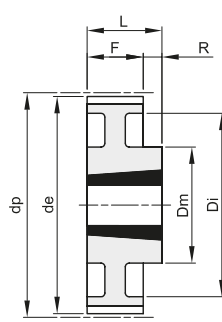

11

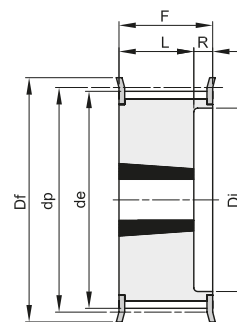

16F

Materiale: Acciaio (St)
Materiale: Ghisa (GG)

| descrizione | codice | tipo | materiale | denti | bussola | foro max | dp | de | Df | Dm | Di | F | L | R | n° flangia | Kg. |
|-------------|----------|------|-----------|-------|---------|----------|--------|--------|-----|-----|-----|----|----|---|------------|------|
| TL 22 8M 20 | 47020022 | 16F | St | 22 | 1008 | 25 | 56,02 | 54,65 | 60 | | 37 | 28 | 22 | 6 | 308 | 0,25 |
| TL 24 8M 20 | 47020024 | 16F | St | 24 | 1108 | 25 | 61,11 | 59,74 | 66 | | 44 | 28 | 22 | 6 | 310 | 0,30 |
| TL 26 8M 20 | 47020026 | 16F | St | 26 | 1108 | 25 | 66,21 | 64,84 | 71 | | 45 | 28 | 22 | 6 | 311 | 0,36 |
| TL 28 8M 20 | 47020028 | 16F | St | 28 | 1108 | 25 | 71,30 | 70,08 | 75 | | 50 | 28 | 22 | 6 | 312 | 0,45 |
| TL 30 8M 20 | 47020030 | 16F | St | 30 | 1108 | 25 | 76,39 | 75,13 | 83 | | 58 | 28 | 22 | 6 | 314 | 0,55 |
| TL 32 8M 20 | 47020032 | 16F | St | 32 | 1610 | 42 | 81,49 | 80,16 | 87 | | 63 | 28 | 25 | 3 | 315 | 0,43 |
| TL 34 8M 20 | 47020034 | 16F | St | 34 | 1610 | 42 | 86,58 | 85,21 | 91 | | 64 | 28 | 25 | 3 | 316 | 0,57 |
| TL 36 8M 20 | 47020036 | 16F | St | 36 | 1610 | 42 | 91,67 | 90,30 | 98 | | 68 | 28 | 25 | 3 | 319 | 0,70 |
| TL 38 8M 20 | 47020038 | 16F | St | 38 | 1610 | 42 | 96,77 | 95,39 | 103 | | 72 | 28 | 25 | 3 | 320 | 0,82 |
| TL 40 8M 20 | 47020040 | 16F | St | 40 | 1610 | 42 | 101,86 | 100,49 | 106 | | 76 | 28 | 25 | 3 | 321 | 1,10 |
| TL 44 8M 20 | 47020044 | 10F | St | 44 | 2012 | 50 | 112,05 | 110,67 | 119 | 92 | | 28 | 32 | 4 | 325 | 1,20 |
| TL 48 8M 20 | 47020048 | 10F | St | 48 | 2012 | 50 | 122,23 | 120,86 | 127 | 96 | | 28 | 32 | 4 | 327 | 1,65 |
| TL 56 8M 20 | 47020056 | 10F | St | 56 | 2012 | 50 | 142,60 | 141,23 | 148 | 110 | | 28 | 32 | 4 | 333 | 2,50 |
| TL 64 8M 20 | 47020064 | 11F | St | 64 | 2012 | 50 | 162,97 | 161,60 | 168 | 110 | 137 | 28 | 32 | 4 | 338 | 2,60 |
| TL 72 8M 20 | 47020072 | 11F | St | 72 | 2012 | 50 | 183,35 | 181,97 | 192 | 110 | 158 | 28 | 32 | 4 | 340 | 3,40 |
| TL 80 8M 20 | 47020080 | 11 | GG | 80 | 2012 | 50 | 203,72 | 202,35 | | 110 | 180 | 28 | 32 | 4 | | 3,60 |
| TL 90 8M 20 | 47020090 | 11 | GG | 90 | 2012 | 50 | 229,18 | 227,81 | | 110 | 204 | 28 | 32 | 4 | | 4,10 |



PULEGGE DENTATE A BUSSOLA CONICA PER CINGHIE HTD® HTD® TIMING BELT PULLEYS FOR TAPER BUSHES

8M

PASSO 8 mm

PER CINGHIE LARGHEZZA 30 mm

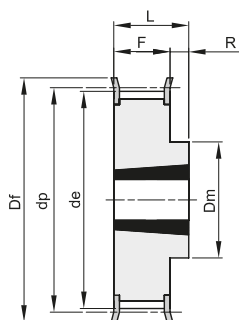

10F

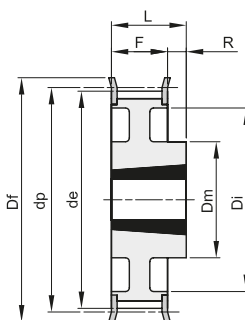

11F

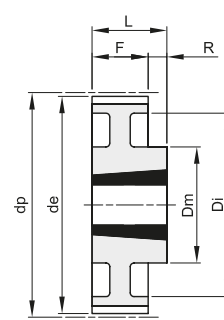

11

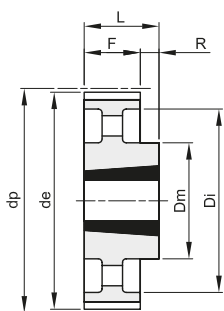

12

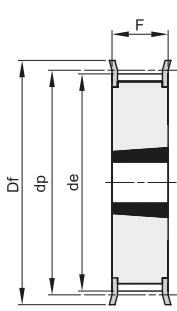

15F

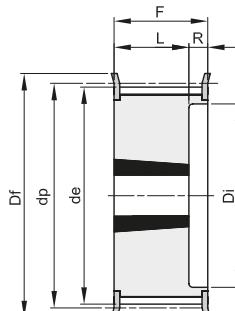

16F

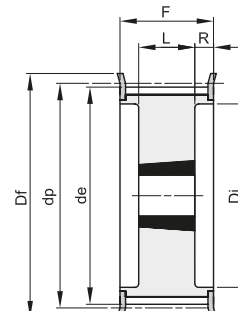

18F

Materiale: Acciaio (St)
Materiale: Ghisa (GG)

| descrizione | codice | tipo | materiale | denti | bussola | foro max | dp | de | Df | Dm | Di | F | L | R | n° flangia | Kg. |
|-------------|----------|------|-----------|-------|---------|----------|--------|--------|-----|-----|-----|----|----|----|------------|------|
| TL 22 8M 30 | 47030022 | 16F | St | 22 | 1008 | 25 | 56,02 | 54,65 | 60 | | 37 | 38 | 22 | 16 | 308 | 0,33 |
| TL 24 8M 30 | 47030024 | 16F | St | 24 | 1108 | 25 | 61,11 | 59,74 | 66 | | 44 | 38 | 22 | 16 | 310 | 0,40 |
| TL 26 8M 30 | 47030026 | 16F | St | 26 | 1108 | 25 | 66,21 | 64,84 | 71 | | 44 | 38 | 22 | 16 | 311 | 0,45 |
| TL 28 8M 30 | 47030028 | 16F | St | 28 | 1210 | 32 | 71,30 | 70,08 | 75 | | 50 | 38 | 25 | 13 | 312 | 0,50 |
| TL 30 8M 30 | 47030030 | 15F | St | 30 | 1615 | 42 | 76,39 | 75,13 | 83 | | | 38 | 38 | | 314 | 0,55 |
| TL 32 8M 30 | 47030032 | 15F | St | 32 | 1615 | 42 | 81,49 | 80,16 | 87 | | | 38 | 38 | | 315 | 0,60 |
| TL 34 8M 30 | 47030034 | 15F | St | 34 | 1615 | 42 | 86,58 | 85,21 | 91 | | | 38 | 38 | | 316 | 0,80 |
| TL 36 8M 30 | 47030036 | 15F | St | 36 | 1615 | 42 | 91,67 | 90,30 | 98 | | | 38 | 38 | | 319 | 1,00 |
| TL 38 8M 30 | 47030038 | 15F | St | 38 | 1615 | 42 | 96,77 | 95,39 | 103 | | | 38 | 38 | | 320 | 1,10 |
| TL 40 8M 30 | 47030040 | 15F | St | 40 | 1615 | 42 | 101,86 | 100,49 | 106 | | | 38 | 38 | | 321 | 1,34 |
| TL 44 8M 30 | 47030044 | 18F | St | 44 | 2012 | 50 | 112,05 | 110,67 | 119 | | 86 | 38 | 32 | 3 | 325 | 1,30 |
| TL 48 8M 30 | 47030048 | 18F | St | 48 | 2012 | 50 | 122,23 | 120,86 | 127 | | 90 | 38 | 32 | 3 | 327 | 1,80 |
| TL 56 8M 30 | 47030056 | 18F | St | 56 | 2012 | 50 | 142,60 | 141,23 | 148 | | 110 | 38 | 32 | 3 | 333 | 3,80 |
| TL 64 8M 30 | 47030064 | 10F | St | 64 | 2517 | 60 | 162,97 | 161,60 | 168 | 125 | | 38 | 45 | 7 | 338 | 4,30 |
| TL 72 8M 30 | 47030072 | 11F | St | 72 | 2517 | 60 | 183,35 | 181,97 | 192 | 125 | 158 | 38 | 45 | 7 | 340 | 4,40 |
| TL 80 8M 30 | 47030080 | 11 | GG | 80 | 2517 | 60 | 203,72 | 202,35 | | 125 | 180 | 38 | 45 | 7 | | 4,65 |
| TL 90 8M 30 | 47030090 | 11 | GG | 90 | 2517 | 60 | 229,18 | 227,81 | | 125 | 204 | 38 | 45 | 7 | | 5,80 |
| TL112 8M 30 | 47030112 | 12 | GG | 112 | 2517 | 60 | 285,21 | 283,83 | | 125 | 254 | 38 | 45 | 7 | | 6,20 |
| TL144 8M 30 | 47030144 | 12 | GG | 144 | 2517 | 60 | 366,69 | 365,32 | | 125 | 336 | 38 | 45 | 7 | | 9,00 |



PULEGGE DENTATE A BUSSOLA CONICA PER CINGHIE HTD® HTD® TIMING BELT PULLEYS FOR TAPER BUSHES

8M

PASSO 8 mm

PER CINGHIE LARGHEZZA 50 mm

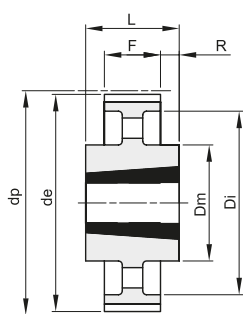

14

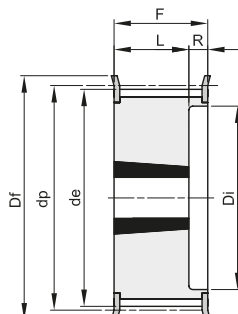

16F

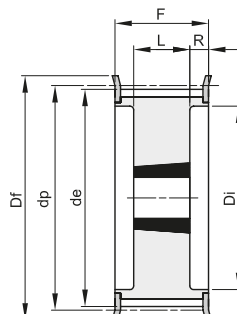

18F

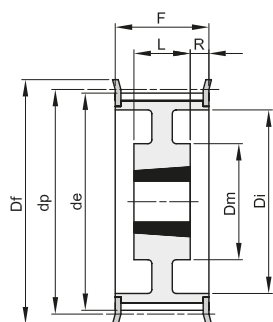

19F

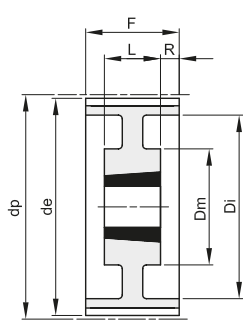

19

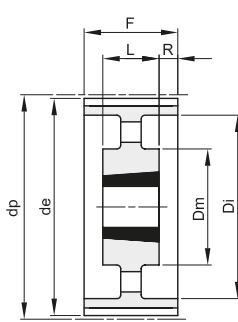

20

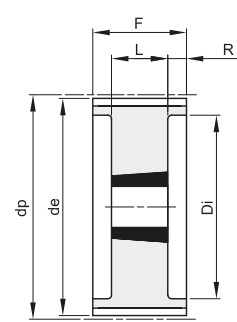

18

Materiale: Acciaio (St)
Materiale: Ghisa (GG)

| descrizione | codice | tipo | materiale | denti | bussola | foro max | dp | de | Df | Dm | Di | F | L | R | n° flangia | Kg. |
|-------------|----------|------|-----------|-------|---------|----------|--------|--------|-----|-----|-----|----|----|-----|------------|-------|
| TL 28 8M 50 | 47050028 | 16F | St | 28 | 1210 | 32 | 71,30 | 70,08 | 75 | | 50 | 60 | 25 | 35 | 312 | 0,60 |
| TL 30 8M 50 | 47050030 | 16F | St | 30 | 1615 | 42 | 76,39 | 75,13 | 83 | | 58 | 60 | 38 | 22 | 314 | 0,65 |
| TL 32 8M 50 | 47050032 | 16F | St | 32 | 1615 | 42 | 81,49 | 80,16 | 87 | | 63 | 60 | 38 | 22 | 315 | 0,80 |
| TL 34 8M 50 | 47050034 | 16F | St | 34 | 1615 | 42 | 86,58 | 85,21 | 91 | | 65 | 60 | 38 | 22 | 316 | 1,08 |
| TL 36 8M 50 | 47050036 | 16F | St | 36 | 1615 | 42 | 91,67 | 90,30 | 98 | | 68 | 60 | 38 | 22 | 319 | 1,35 |
| TL 38 8M 50 | 47050038 | 16F | St | 38 | 1615 | 42 | 96,77 | 95,39 | 103 | | 72 | 60 | 38 | 22 | 320 | 1,65 |
| TL 40 8M 50 | 47050040 | 18F | St | 40 | 2012 | 50 | 101,86 | 100,49 | 106 | | 80 | 60 | 32 | 14 | 321 | 1,70 |
| TL 44 8M 50 | 47050044 | 18F | St | 44 | 2012 | 50 | 112,05 | 110,67 | 119 | | 86 | 60 | 32 | 14 | 325 | 1,80 |
| TL 48 8M 50 | 47050048 | 18F | St | 48 | 2012 | 50 | 122,23 | 120,86 | 127 | | 95 | 60 | 32 | 14 | 327 | 2,35 |
| TL 56 8M 50 | 47050056 | 18F | St | 56 | 2517 | 60 | 142,60 | 141,23 | 148 | | 116 | 60 | 45 | 7,5 | 333 | 3,35 |
| TL 64 8M 50 | 47050064 | 18F | St | 64 | 2517 | 60 | 162,97 | 161,60 | 168 | | 136 | 60 | 45 | 7,5 | 338 | 4,90 |
| TL 72 8M 50 | 47050072 | 19F | St | 72 | 2517 | 60 | 183,35 | 181,97 | 192 | 125 | 158 | 60 | 45 | 7,5 | 340 | 6,90 |
| TL 80 8M 50 | 47050080 | 18 | GG | 80 | 3020 | 75 | 203,72 | 202,35 | | | 180 | 60 | 51 | 4,5 | | 8,90 |
| TL 90 8M 50 | 47050090 | 19 | GG | 90 | 3020 | 75 | 229,18 | 227,81 | | 160 | 204 | 60 | 51 | 4,5 | | 9,90 |
| TL112 8M 50 | 47050112 | 19 | GG | 112 | 3020 | 75 | 285,21 | 283,83 | | 170 | 254 | 60 | 51 | 4,5 | | 12,10 |
| TL144 8M 50 | 47050144 | 20 | GG | 144 | 3020 | 75 | 366,69 | 365,32 | | 170 | 336 | 60 | 51 | 4,5 | | 15,40 |
| TL168 8M 50 | 47050168 | 14 | GG | 168 | 3525 | 90 | 427,81 | 426,44 | | 198 | 395 | 60 | 65 | 2,5 | | 22,80 |
| TL192 8M 50 | 47050192 | 14 | GG | 192 | 3525 | 90 | 488,92 | 487,55 | | 198 | 455 | 60 | 65 | 2,5 | | 26,50 |



PULEGGE DENTATE A BUSSOLA CONICA PER CINGHIE HTD®

HTD® TIMING BELT PULLEYS FOR TAPER BUSHES

8M

PASSO 8 mm

PER CINGHIE LARGHEZZA 85 mm

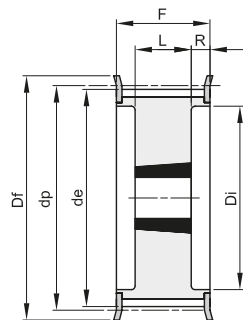

18F

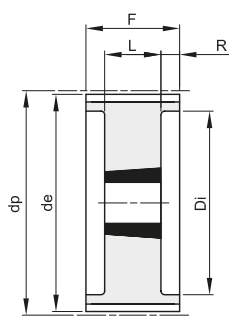

18

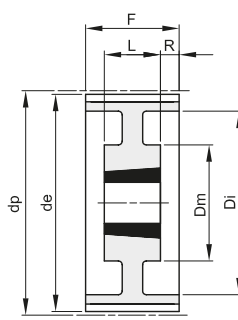

19

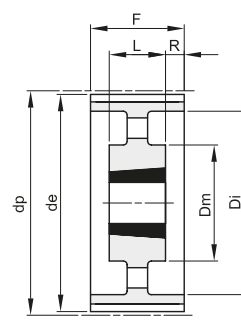

20

Materiale: Acciaio (St)
Materiale: Ghisa (GG)

| descrizione | codice | tipo | materiale | denti | bussola | foro max | dp | de | Df | Dm | Di | F | L | R | n° flangia | Kg. |
|-------------|----------|------|-----------|-------|---------|----------|--------|--------|-----|-----|-----|----|----|------|------------|-------|
| TL 34 8M 85 | 47085034 | 18F | St | 34 | 1615 | 42 | 86,58 | 85,22 | 91 | | 65 | 95 | 38 | 28,5 | 316 | 1,50 |
| TL 36 8M 85 | 47085036 | 18F | St | 36 | 1615 | 42 | 91,67 | 90,30 | 98 | | 68 | 95 | 38 | 28,5 | 319 | 1,90 |
| TL 38 8M 85 | 47085038 | 18F | St | 38 | 1615 | 42 | 96,77 | 95,39 | 103 | | 72 | 95 | 38 | 28,5 | 320 | 2,20 |
| TL 40 8M 85 | 47085040 | 18F | St | 40 | 2012 | 50 | 101,86 | 100,49 | 106 | | 80 | 95 | 32 | 31,5 | 321 | 1,90 |
| TL 44 8M 85 | 47085044 | 18F | St | 44 | 2012 | 50 | 112,05 | 110,67 | 119 | | 86 | 95 | 32 | 31,5 | 325 | 2,30 |
| TL 48 8M 85 | 47085048 | 18F | St | 48 | 2517 | 60 | 122,23 | 120,86 | 127 | | 97 | 95 | 45 | 25 | 327 | 2,70 |
| TL 56 8M 85 | 47085056 | 18F | St | 56 | 2517 | 60 | 142,60 | 141,23 | 148 | | 116 | 95 | 45 | 25 | 333 | 4,50 |
| TL 64 8M 85 | 47085064 | 18F | St | 64 | 2517 | 60 | 162,97 | 161,60 | 168 | | 136 | 95 | 45 | 25 | 338 | 6,30 |
| TL 72 8M 85 | 47085072 | 18F | St | 72 | 3020 | 75 | 183,35 | 181,97 | 192 | | 150 | 95 | 51 | 22 | 340 | 8,10 |
| TL 80 8M 85 | 47085080 | 18 | GG | 80 | 3020 | 75 | 203,72 | 202,35 | | | 180 | 95 | 51 | 22 | | 10,20 |
| TL 90 8M 85 | 47085090 | 19 | GG | 90 | 3020 | 75 | 229,18 | 227,81 | | 170 | 204 | 95 | 51 | 22 | | 11,20 |
| TL112 8M 85 | 47085112 | 19 | GG | 112 | 3020 | 75 | 285,21 | 283,83 | | 170 | 254 | 95 | 51 | 22 | | 15,00 |
| TL144 8M 85 | 47085144 | 20 | GG | 144 | 3525 | 90 | 366,69 | 365,32 | | 198 | 336 | 95 | 65 | 15 | | 20,20 |
| TL168 8M 85 | 47085168 | 20 | GG | 168 | 3525 | 90 | 427,81 | 426,44 | | 198 | 395 | 95 | 65 | 15 | | 22,40 |
| TL192 8M 85 | 47085192 | 20 | GG | 192 | 3525 | 90 | 488,92 | 487,55 | | 198 | 455 | 95 | 65 | 15 | | 28,20 |



PULEGGE DENTATE A BUSSOLA CONICA PER CINGHIE HTD®

HTD® TIMING BELT PULLEYS FOR TAPER BUSHES

14M

PASSO 14 mm

PER CINGHIE LARGHEZZA 40 mm

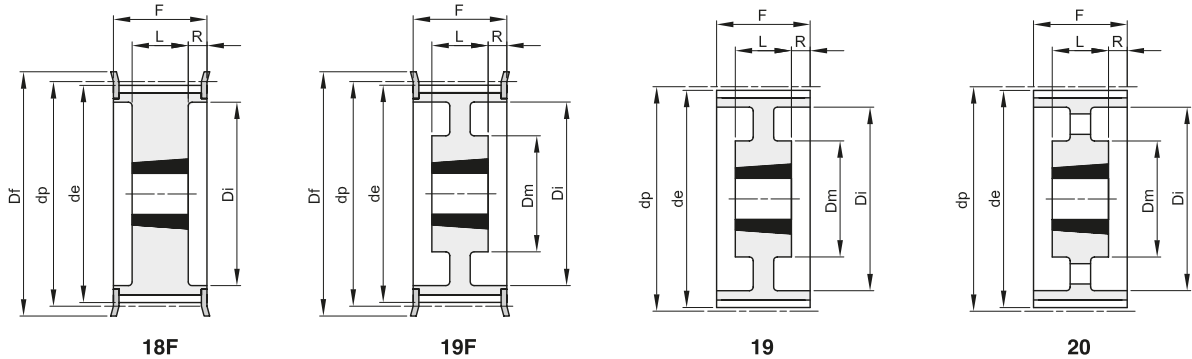

Materiale: Acciaio (St)
Materiale: Ghisa (GG)

| descrizione | codice | tipo | materiale | denti | bussola | foro max | dp | de | Df | Dm | Di | F | L | R | n° flangia | Kg. |
|--------------|----------|------|-----------|-------|---------|----------|--------|--------|-----|-----|-----|----|----|-----|------------|-------|
| TL 28 14M 40 | 48040028 | 18F | St | 28 | 2012 | 50 | 124,78 | 122,12 | 127 | | 94 | 54 | 32 | 11 | 400 | 2,10 |
| TL 30 14M 40 | 48040030 | 18F | St | 30 | 2012 | 50 | 133,69 | 130,99 | 138 | | 98 | 54 | 32 | 11 | 401 | 2,70 |
| TL 32 14M 40 | 48040032 | 18F | St | 32 | 2012 | 50 | 142,60 | 139,88 | 154 | | 108 | 54 | 32 | 11 | 403 | 3,40 |
| TL 34 14M 40 | 48040034 | 18F | St | 34 | 2517 | 60 | 151,52 | 148,79 | 160 | | 110 | 54 | 45 | 4,5 | 404 | 3,90 |
| TL 36 14M 40 | 48040036 | 18F | St | 36 | 2517 | 60 | 160,43 | 157,68 | 168 | | 120 | 54 | 45 | 4,5 | 405 | 4,80 |
| TL 38 14M 40 | 48040038 | 18F | St | 38 | 2517 | 60 | 169,34 | 166,60 | 183 | | 130 | 54 | 45 | 4,5 | 406 | 5,40 |
| TL 40 14M 40 | 48040040 | 18F | St | 40 | 2517 | 60 | 178,25 | 175,49 | 188 | | 138 | 54 | 45 | 4,5 | 407 | 6,00 |
| TL 44 14M 40 | 48040044 | 18F | St | 44 | 3020 | 75 | 196,08 | 193,28 | 211 | | 155 | 54 | 51 | 1,5 | 411 | 7,70 |
| TL 48 14M 40 | 48040048 | 18F | St | 48 | 3020 | 75 | 213,90 | 211,11 | 226 | | 170 | 54 | 51 | 1,5 | 412 | 9,90 |
| TL 56 14M 40 | 48040056 | 18F | GG | 56 | 3020 | 75 | 249,55 | 246,76 | 256 | | 208 | 54 | 51 | 1,5 | 416 | 10,70 |
| TL 64 14M 40 | 48040064 | 19F | GG | 64 | 3020 | 75 | 285,21 | 282,41 | 296 | 170 | 240 | 54 | 51 | 1,5 | 418 | 13,30 |
| TL 72 14M 40 | 48040072 | 19 | GG | 72 | 3020 | 75 | 320,86 | 318,06 | | 170 | 280 | 54 | 51 | 1,5 | | 15,00 |
| TL 80 14M 40 | 48040080 | 20 | GG | 80 | 3020 | 75 | 356,51 | 353,71 | | 170 | 315 | 54 | 51 | 1,5 | | 16,00 |
| TL 90 14M 40 | 48040090 | 20 | GG | 90 | 3020 | 75 | 401,07 | 398,28 | | 170 | 360 | 54 | 51 | 1,5 | | 18,00 |
| TL112 14M 40 | 48040112 | 20 | GG | 112 | 3020 | 75 | 499,11 | 496,32 | | 170 | 457 | 54 | 51 | 1,5 | | 25,50 |
| TL144 14M 40 | 48040144 | 20 | GG | 144 | 3020 | 75 | 641,71 | 638,92 | | 170 | 600 | 54 | 51 | 1,5 | | 32,00 |
| TL168 14M 40 | 48040168 | 20 | GG | 168 | 3020 | 75 | 748,66 | 745,87 | | 170 | 706 | 54 | 51 | 1,5 | | 43,50 |
| TL192 14M 40 | 48040192 | 20 | GG | 192 | 3020 | 75 | 855,62 | 852,82 | | 170 | 813 | 54 | 51 | 1,5 | | 49,50 |



PULEGGE DENTATE A BUSSOLA CONICA PER CINGHIE HTD®

HTD® TIMING BELT PULLEYS FOR TAPER BUSHES

14M

PASSO 14 mm

PER CINGHIE LARGHEZZA 55 mm

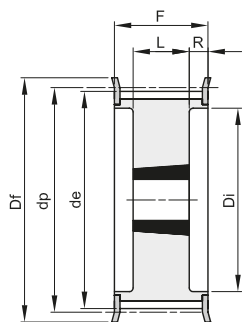

18F

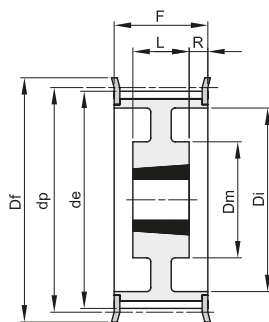

19F

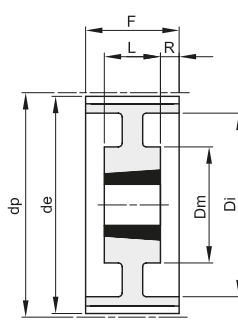

19

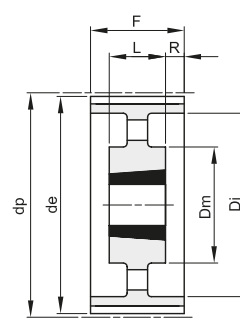

20

Materiale: Acciaio (St)
Materiale: Ghisa (GG)

| descrizione | codice | tipo | materiale | denti | bussola | foro max | dp | de | Df | Dm | Di | F | L | R | n° flangia | Kg. |
|--------------|----------|------|-----------|-------|---------|----------|--------|--------|-----|-----|-----|----|----|------|------------|-------|
| TL 28 14M 55 | 48055028 | 18F | St | 28 | 2012 | 50 | 124,78 | 122,12 | 127 | | 94 | 70 | 32 | 19 | 400 | 2,20 |
| TL 30 14M 55 | 48055030 | 18F | St | 30 | 2517 | 60 | 133,69 | 130,99 | 138 | | 100 | 70 | 45 | 12,5 | 401 | 2,70 |
| TL 32 14M 55 | 48055032 | 18F | St | 32 | 2517 | 60 | 142,60 | 139,88 | 154 | | 108 | 70 | 45 | 12,5 | 403 | 3,60 |
| TL 34 14M 55 | 48055034 | 18F | St | 34 | 2517 | 60 | 151,52 | 148,79 | 160 | | 110 | 70 | 45 | 12,5 | 404 | 4,50 |
| TL 36 14M 55 | 48055036 | 18F | St | 36 | 2517 | 60 | 160,43 | 157,68 | 168 | | 120 | 70 | 45 | 12,5 | 405 | 5,20 |
| TL 38 14M 55 | 48055038 | 18F | St | 38 | 2517 | 60 | 169,34 | 166,60 | 183 | | 130 | 70 | 45 | 12,5 | 406 | 6,20 |
| TL 40 14M 55 | 48055040 | 18F | St | 40 | 2517 | 60 | 178,25 | 175,49 | 188 | | 138 | 70 | 45 | 12,5 | 407 | 6,90 |
| TL 44 14M 55 | 48055044 | 18F | St | 44 | 3020 | 75 | 196,08 | 193,28 | 211 | | 155 | 70 | 51 | 9,5 | 411 | 8,60 |
| TL 48 14M 55 | 48055048 | 18F | St | 48 | 3020 | 75 | 213,90 | 211,11 | 226 | | 170 | 70 | 51 | 9,5 | 412 | 10,50 |
| TL 56 14M 55 | 48055056 | 18F | GG | 56 | 3020 | 75 | 249,55 | 246,76 | 256 | | 208 | 70 | 51 | 9,5 | 416 | 12,50 |
| TL 64 14M 55 | 48055064 | 19F | GG | 64 | 3020 | 75 | 285,21 | 282,41 | 296 | 170 | 240 | 70 | 51 | 9,5 | 418 | 15,60 |
| TL 72 14M 55 | 48055072 | 19 | GG | 72 | 3020 | 75 | 320,86 | 318,06 | | 170 | 280 | 70 | 51 | 9,5 | | 17,45 |
| TL 80 14M 55 | 48055080 | 20 | GG | 80 | 3020 | 75 | 356,51 | 353,71 | | 170 | 315 | 70 | 51 | 9,5 | | 17,45 |
| TL 90 14M 55 | 48055090 | 20 | GG | 90 | 3020 | 75 | 401,07 | 398,28 | | 170 | 360 | 70 | 51 | 9,5 | | 19,90 |
| TL112 14M 55 | 48055112 | 20 | GG | 112 | 3020 | 75 | 499,11 | 496,32 | | 170 | 457 | 70 | 51 | 9,5 | | 27,50 |
| TL144 14M 55 | 48055144 | 20 | GG | 144 | 3020 | 75 | 641,71 | 638,92 | | 170 | 600 | 70 | 51 | 9,5 | | 37,00 |
| TL168 14M 55 | 48055168 | 20 | GG | 168 | 3020 | 75 | 748,66 | 745,87 | | 170 | 706 | 70 | 51 | 9,5 | | 50,00 |
| TL192 14M 55 | 48055192 | 20 | GG | 192 | 3020 | 75 | 855,62 | 852,82 | | 170 | 813 | 70 | 51 | 9,5 | | 62,00 |



PULEGGE DENTATE A BUSSOLA CONICA PER CINGHIE HTD®

HTD® TIMING BELT PULLEYS FOR TAPER BUSHES

14M

PASSO 14 mm

PER CINGHIE LARGHEZZA 85 mm

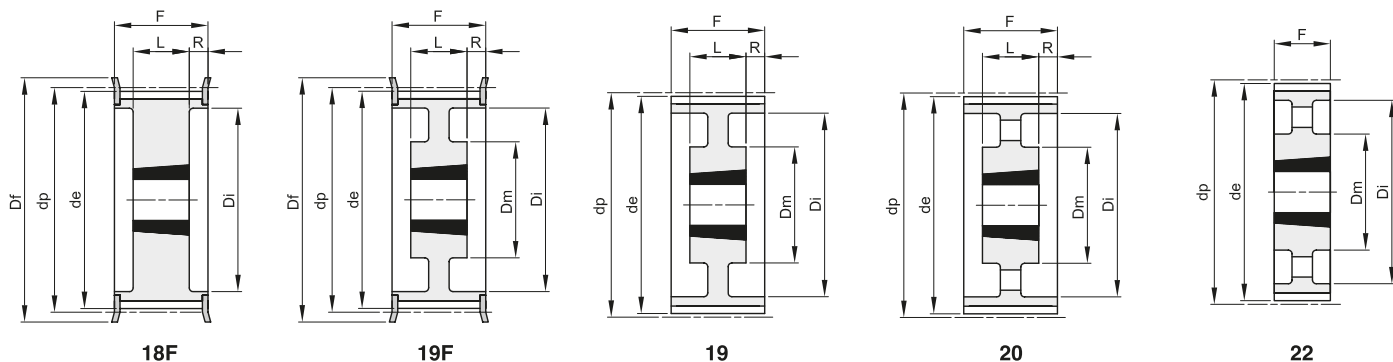

Materiale: Acciaio (St)
Materiale: Ghisa (GG)

| descrizione | codice | tipo | materiale | denti | bussola | foro max | dp | de | Df | Dm | Di | F | L | R | n° flangia | Kg. |
|--------------|----------|------|-----------|-------|---------|----------|--------|--------|-----|-----|-----|-----|-----|------|------------|-------|
| TL 28 14M 85 | 48085028 | 18F | St | 28 | 2517 | 60 | 124,78 | 122,12 | 127 | | 98 | 102 | 45 | 28,5 | 400 | 2,70 |
| TL 30 14M 85 | 48085030 | 18F | St | 30 | 2517 | 60 | 133,69 | 130,99 | 138 | | 100 | 102 | 45 | 28,5 | 401 | 3,80 |
| TL 32 14M 85 | 48085032 | 18F | St | 32 | 2517 | 60 | 142,60 | 139,88 | 154 | | 108 | 102 | 45 | 28,5 | 403 | 4,70 |
| TL 34 14M 85 | 48085034 | 18F | St | 34 | 2517 | 60 | 151,52 | 148,79 | 160 | | 110 | 102 | 45 | 28,5 | 404 | 6,00 |
| TL 36 14M 85 | 48085036 | 18F | St | 36 | 3020 | 75 | 160,43 | 157,68 | 168 | | 125 | 102 | 51 | 25,5 | 405 | 5,70 |
| TL 38 14M 85 | 48085038 | 18F | St | 38 | 3020 | 75 | 169,34 | 166,60 | 183 | | 130 | 102 | 51 | 25,5 | 406 | 6,80 |
| TL 40 14M 85 | 48085040 | 18F | St | 40 | 3020 | 75 | 178,25 | 175,49 | 188 | | 138 | 102 | 51 | 25,5 | 407 | 8,00 |
| TL 44 14M 85 | 48085044 | 18F | St | 44 | 3030 | 75 | 196,08 | 193,28 | 211 | | 155 | 102 | 76 | 13 | 411 | 11,70 |
| TL 48 14M 85 | 48085048 | 18F | St | 48 | 3030 | 75 | 213,90 | 211,11 | 226 | | 170 | 102 | 76 | 13 | 412 | 15,00 |
| TL 56 14M 85 | 48085056 | 18F | GG | 56 | 3525 | 90 | 249,55 | 246,76 | 256 | | 210 | 102 | 65 | 18,5 | 416 | 19,00 |
| TL 64 14M 85 | 48085064 | 19F | GG | 64 | 3525 | 90 | 285,21 | 282,41 | 296 | 190 | 240 | 102 | 65 | 18,5 | 418 | 23,50 |
| TL 72 14M 85 | 48085072 | 19 | GG | 72 | 3525 | 90 | 320,86 | 318,06 | | 190 | 280 | 102 | 65 | 18,5 | | 25,00 |
| TL 80 14M 85 | 48085080 | 20 | GG | 80 | 3525 | 90 | 356,51 | 353,71 | | 190 | 315 | 102 | 65 | 18,5 | | 26,00 |
| TL 90 14M 85 | 48085090 | 20 | GG | 90 | 3525 | 90 | 401,07 | 398,28 | | 190 | 360 | 102 | 65 | 18,5 | | 28,00 |
| TL112 14M 85 | 48085112 | 20 | GG | 112 | 3525 | 90 | 499,11 | 496,32 | | 190 | 457 | 102 | 65 | 18,5 | | 36,00 |
| TL144 14M 85 | 48085144 | 20 | GG | 144 | 3525 | 90 | 641,71 | 638,92 | | 190 | 600 | 102 | 65 | 18,5 | | 48,00 |
| TL168 14M 85 | 48085168 | 20 | GG | 168 | 3525 | 90 | 748,66 | 745,87 | | 190 | 706 | 102 | 65 | 18,5 | | 60,00 |
| TL192 14M 85 | 48085192 | 22 | GG | 192 | 4040 | 100 | 855,62 | 852,82 | | 230 | 813 | 102 | 102 | | | 85,00 |



PULEGGE DENTATE A BUSSOLA CONICA PER CINGHIE HTD®

HTD® TIMING BELT PULLEYS FOR TAPER BUSHES

14M

PASSO 14 mm

PER CINGHIE LARGHEZZA 115 mm

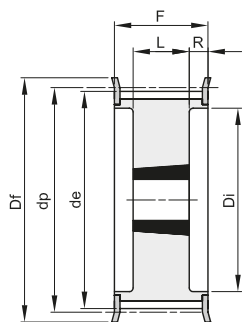

18F

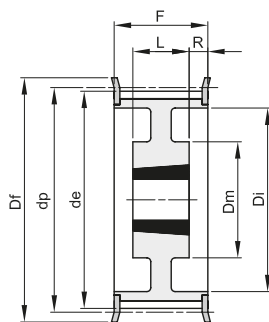

19F

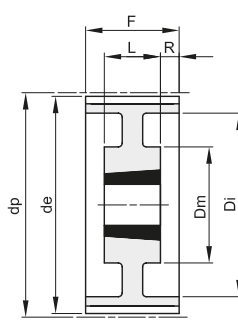

19

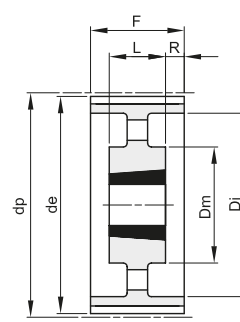

20

Materiale: Acciaio (St)
Materiale: Ghisa (GG)

| descrizione | codice | tipo | materiale | denti | bussola | foro max | dp | de | Df | Dm | Di | F | L | R | n° flangia | Kg. |
|---------------|----------|------|-----------|-------|---------|----------|--------|--------|-----|-----|-----|-----|-----|------|------------|-------|
| TL 28 14M 115 | 48115028 | 18F | St | 28 | 2517 | 60 | 124,78 | 122,12 | 127 | | 98 | 133 | 45 | 44 | 400 | 3,80 |
| TL 30 14M 115 | 48115030 | 18F | St | 30 | 2517 | 60 | 133,69 | 130,99 | 138 | | 100 | 133 | 45 | 44 | 401 | 5,00 |
| TL 32 14M 115 | 48115032 | 18F | St | 32 | 2517 | 60 | 142,60 | 139,88 | 154 | | 108 | 133 | 45 | 44 | 403 | 6,80 |
| TL 34 14M 115 | 48115034 | 18F | St | 34 | 2517 | 60 | 151,52 | 148,79 | 160 | | 110 | 133 | 45 | 44 | 404 | 6,90 |
| TL 36 14M 115 | 48115036 | 18F | St | 36 | 3020 | 75 | 160,43 | 157,68 | 168 | | 125 | 133 | 51 | 41 | 405 | 7,00 |
| TL 38 14M 115 | 48115038 | 18F | St | 38 | 3020 | 75 | 169,34 | 166,60 | 183 | | 130 | 133 | 51 | 41 | 406 | 8,50 |
| TL 40 14M 115 | 48115040 | 18F | St | 40 | 3020 | 75 | 178,25 | 175,49 | 188 | | 138 | 133 | 51 | 41 | 407 | 9,10 |
| TL 44 14M 115 | 48115044 | 18F | St | 44 | 3030 | 75 | 196,08 | 193,28 | 211 | | 155 | 133 | 76 | 28,5 | 411 | 13,00 |
| TL 48 14M 115 | 48115048 | 18F | St | 48 | 3030 | 75 | 213,90 | 211,11 | 226 | | 170 | 133 | 76 | 28,5 | 412 | 16,00 |
| TL 56 14M 115 | 48115056 | 18F | GG | 56 | 3535 | 90 | 249,55 | 246,76 | 256 | | 210 | 133 | 89 | 22 | 416 | 24,00 |
| TL 64 14M 115 | 48115064 | 19F | GG | 64 | 3535 | 90 | 285,21 | 282,41 | 296 | 190 | 240 | 133 | 89 | 22 | 418 | 32,00 |
| TL 72 14M 115 | 48115072 | 19 | GG | 72 | 3535 | 90 | 320,86 | 318,06 | | 190 | 280 | 133 | 89 | 22 | | 31,00 |
| TL 80 14M 115 | 48115080 | 20 | GG | 80 | 3535 | 90 | 356,51 | 353,71 | | 190 | 315 | 133 | 89 | 22 | | 32,00 |
| TL 90 14M 115 | 48115090 | 20 | GG | 90 | 3535 | 90 | 401,07 | 398,28 | | 190 | 360 | 133 | 89 | 22 | | 37,00 |
| TL112 14M 115 | 48115112 | 20 | GG | 112 | 3535 | 90 | 499,11 | 496,32 | | 190 | 457 | 133 | 89 | 22 | | 45,00 |
| TL144 14M 115 | 48115144 | 20 | GG | 144 | 4040 | 100 | 641,71 | 638,92 | | 230 | 600 | 133 | 102 | 15,5 | | 63,00 |
| TL168 14M 115 | 48115168 | 20 | GG | 168 | 4040 | 100 | 748,66 | 745,87 | | 230 | 706 | 133 | 102 | 15,5 | | 77,50 |
| TL192 14M 115 | 48115192 | 20 | GG | 192 | 4040 | 100 | 855,62 | 852,82 | | 230 | 813 | 133 | 102 | 15,5 | | 95,00 |



PULEGGE DENTATE A BUSSOLA CONICA PER CINGHIE HTD®

HTD® TIMING BELT PULLEYS FOR TAPER BUSHES

14M

PASSO 14 mm

PER CINGHIE LARGHEZZA 170 mm

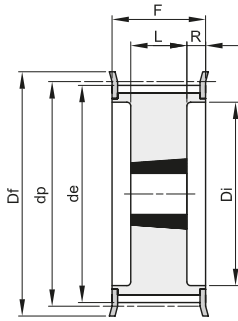

18F

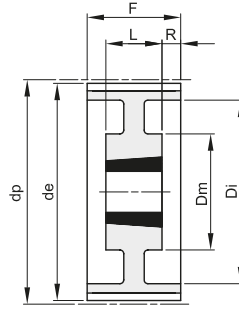

19

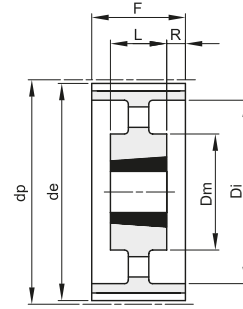

20

Materiale: Acciaio (St)
Materiale: Ghisa (GG)

| descrizione | codice | tipo | materiale | denti | bussola | foro max | dp | de | Df | Dm | Di | F | L | R | n° flangia | Kg. |
|---------------|----------|------|-----------|-------|---------|----------|--------|--------|-----|-----|-----|-----|-----|------|------------|--------|
| TL 38 14M 170 | 48170038 | 18F | St | 38 | 3030 | 75 | 169,34 | 166,60 | 183 | | 130 | 187 | 76 | 55,5 | 406 | 11,70 |
| TL 40 14M 170 | 48170040 | 18F | St | 40 | 3030 | 75 | 178,25 | 175,49 | 188 | | 138 | 187 | 76 | 55,5 | 407 | 13,00 |
| TL 44 14M 170 | 48170044 | 18F | St | 44 | 3535 | 90 | 196,08 | 193,28 | 211 | | 155 | 187 | 89 | 49 | 411 | 15,00 |
| TL 48 14M 170 | 48170048 | 18F | St | 48 | 3535 | 90 | 213,90 | 211,11 | 226 | | 170 | 187 | 89 | 49 | 412 | 19,00 |
| TL 56 14M 170 | 48170056 | 18F | St | 56 | 3535 | 90 | 249,55 | 246,76 | 256 | | 210 | 187 | 89 | 49 | 416 | 28,50 |
| TL 64 14M 170 | 48170064 | 18F | GG | 64 | 4040 | 100 | 285,21 | 282,41 | 296 | | 240 | 187 | 102 | 42,5 | 418 | 41,00 |
| TL 72 14M 170 | 48170072 | 19 | GG | 72 | 4040 | 100 | 320,86 | 318,06 | | 230 | 280 | 187 | 102 | 42,5 | | 47,00 |
| TL 80 14M 170 | 48170080 | 19 | GG | 80 | 4040 | 100 | 356,51 | 353,71 | | 230 | 315 | 187 | 102 | 42,5 | | 48,00 |
| TL 90 14M 170 | 48170090 | 20 | GG | 90 | 4040 | 100 | 401,07 | 398,28 | | 230 | 360 | 187 | 102 | 42,5 | | 52,50 |
| TL112 14M 170 | 48170112 | 20 | GG | 112 | 5050 | 125 | 499,11 | 496,32 | | 265 | 457 | 187 | 127 | 30 | | 74,50 |
| TL144 14M 170 | 48170144 | 20 | GG | 144 | 5050 | 125 | 641,71 | 638,92 | | 265 | 600 | 187 | 127 | 30 | | 91,00 |
| TL168 14M 170 | 48170168 | 20 | GG | 168 | 5050 | 125 | 748,66 | 745,87 | | 265 | 706 | 187 | 127 | 30 | | 116,00 |
| TL192 14M 170 | 48170192 | 20 | GG | 192 | 5050 | 125 | 855,62 | 852,82 | | 265 | 813 | 187 | 127 | 30 | | 134,00 |