

Roller chains with rubber blocks

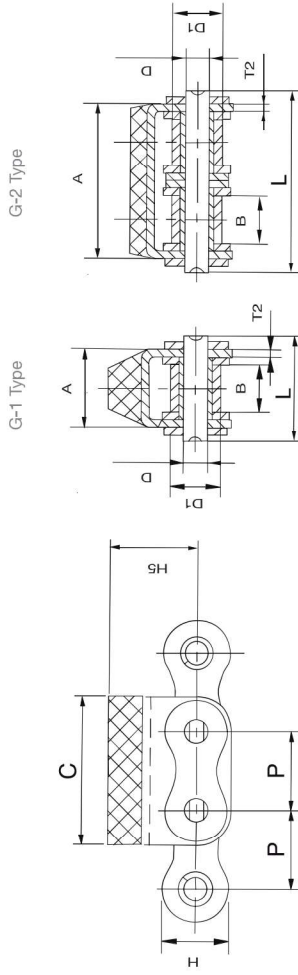

Reference	Pitch	Inner width	Roller diameter	Pin dimensions				Plate and rubber blocks dimensions				Breaking load	Weight per meter		
				D max	D min	L max	L min	H max	H min	A	C			H5	T2
DIN/ISO	P	B min	D1 max	D max	D min	L max	L min	H max	H min	A	C	H5	T2	Q min	q
08B-G1	12,70	7,75	8,51	4,45	4,45	20,0	11,8	14,6	24,2	11,8	14,6	12,3	1,60	18,0	1,19
08B-G2	12,70	7,75	8,51	4,45	4,45	34,3	11,8	28,4	24,2	28,4	24,2	12,3	1,50	32,0	2,07
10B-G1	15,875	9,65	10,16	5,08	5,08	23,2	14,7	16,8	30,0	17,0	17,0	1,70	1,70	22,4	1,62
10B-G2	15,875	9,65	10,16	5,08	5,08	39,7	14,7	33,3	30,0	30,0	30,0	1,70	1,70	44,5	2,56
12B-G1	19,05	11,68	12,07	5,72	5,72	25,7	16,0	19,6	36,0	21,0	18,5	2,00	1,85	29,0	2,01
12B-G2	19,05	11,68	12,07	5,72	5,72	45,3	16,0	39,1	36,0	36,0	16,0	1,85	1,85	57,8	3,21
16B-G1	25,40	17,02	15,88	8,28	8,28	39,7	21,0	29,1	49,0	21,4	1,60	1,60	1,60	58,0	3,83
16B-G2	25,40	17,02	15,88	8,28	8,28	71,58	21,0	61,0	49,0	21,4	1,60	1,60	1,60	116,0	7,32
16A-G1	25,40	15,75	15,88	7,92	7,92	37,2	24,0	27,5	46,0	20,0	2,42	2,42	2,42	42,0	3,97
20B-G1	31,75	19,56	19,05	10,19	10,19	48,0	26,4	36,0	57,0	27,0	3,50	3,50	3,50	85,0	6,19
24B-G1	38,10	25,40	25,40	14,63	14,63	61,6	33,2	47,0	72,6	34,0	4,50	4,50	4,50	160,0	11,25

Roller chains with "U" type attachments

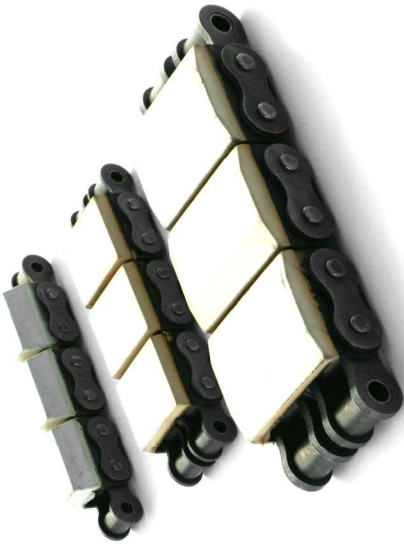
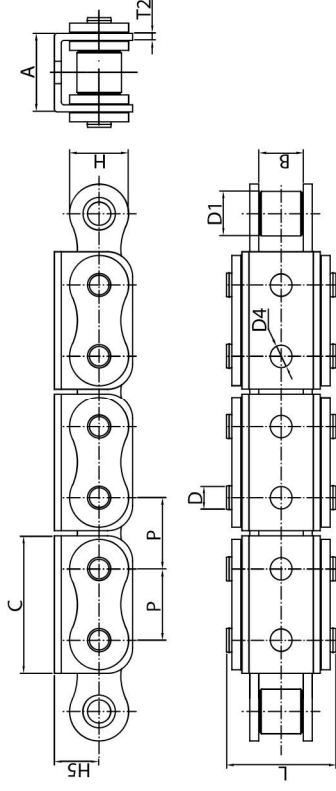

Reference	Pitch	Inner width	Roller diameter	Pin dimensions				Plate and "U" attachment dimensions						Breaking load	Weight per meter
				D max	D min	L max	L min	H	A	C	H5	D4	T2		
DIN/ISO	P	B min	D1 max	D max	D min <td>L max</td> <td>L min <td>H</td> <td>A</td> <td>C</td> <td>H5</td> <td>D4</td> <td>T2</td> <td>Q min</td> <td>q</td> </td>	L max	L min <td>H</td> <td>A</td> <td>C</td> <td>H5</td> <td>D4</td> <td>T2</td> <td>Q min</td> <td>q</td>	H	A	C	H5	D4	T2	Q min	q
08B-U1	12,700	7,75	8,51	4,45	4,45	20,00	11,80	11,80	14,60	24,20	8,30	4,00	1,60	18,00	1,13
08B-U2	12,700	7,75	8,51	4,45	4,45	34,30	11,80	28,40	24,20	24,20	8,30	4,00	1,50	32,00	1,96
10B-U1	15,875	9,65	10,16	5,08	5,08	23,20	14,70	16,80	30,00	30,00	11,30	5,00	1,60	19,00	1,53
10B-U2	15,875	9,65	10,16	5,08	5,08	39,70	14,70	33,30	30,00	30,00	11,30	5,00	1,50	44,50	2,47
12B-U1	19,050	11,68	12,07	5,72	5,72	25,70	16,00	19,60	36,00	36,00	13,00	5,00	1,85	29,00	1,90
12B-U2	19,050	11,68	12,07	5,72	5,72	45,30	16,00	39,10	36,00	36,00	12,00	5,00	1,85	57,80	3,03
16A-U1	25,400	15,75	15,88	7,92	7,92	37,20	24,00	27,50	46,00	46,00	16,00	7,00	2,42	42,00	3,87
16B-U1	25,400	17,02	15,88	8,28	8,28	39,70	21,00	29,05	49,00	49,00	15,40	6,00	1,60	58,00	3,73
16B-U2	25,400	17,02	15,88	8,28	8,28	71,70	21,00	60,93	49,00	49,00	16,20	6,00	1,60	106,00	6,15
20B-U1	31,750	19,56	19,05	10,19	10,19	48,00	26,40	36,00	57,00	57,00	21,00	8,00	3,50	85,00	6,00
24B-U1	38,100	25,40	25,40	14,63	14,63	61,60	33,20	47,00	72,60	72,60	28,00	10,00	4,50	160,00	10,88